

# MBS

## SERIES

Tool Steel  
Single Ended Beam Load Cells

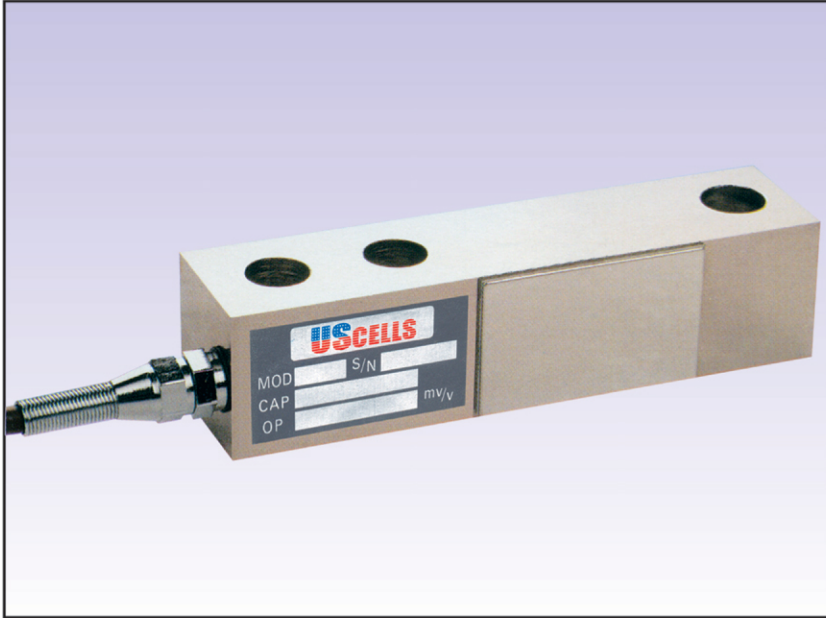

### Dimension:

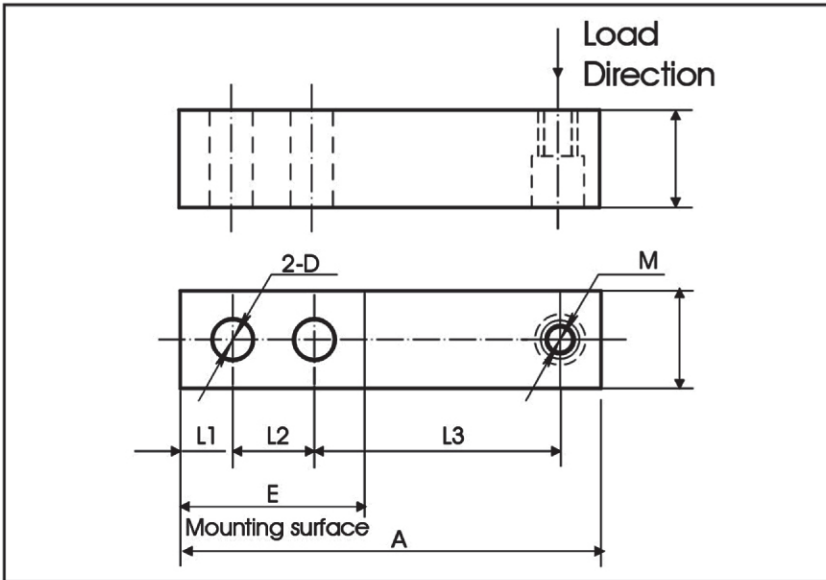

Capacity	A	B	D	E	L1	L2	L3	M
250-4klb	5.12	1.25	0.53	2.25	0.62	1.00	3.00	1/2-20UNF-2B
10klb	6.75	1.50	0.78	3.00	0.75	1.50	3.75	3/4-16UNF-2B
20klb	8.88	2.00	1.03	4.00	1.00	2.00	4.88	1 1/4-12UNF-2B
500kg-2t	130	32	13	57	16	25	76	M 12
5t	171	38	21	76	19	38	95	M 20
10t	226	51	25	102	25	51	124	M 24 X 2

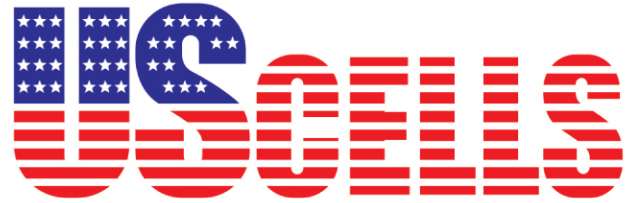

### Load Cell Specification:

Model	MBS
Capacity	250, 500, 1k, 2k, 4k, 10k, 20klb 500, 1000, 2000, 5000, 10,000kg
Sensitivity MV/V	3 ± 0.01
Zero Balance	< 2% of Full Scale
Creep ( 1 hour )	< 0.03% of Full Scale
Non-linearity	< 0.03% of Full Scale
Hysteresis	< 0.03% of Full Scale
Repeatability	< 0.02% of Full Scale
Temperature effect on Output	< 20PPM / °C of Applied Load
Temperature effect on zero	< 20PPM / °C of Applied Load
Operating temperature range	- 20 °C to 60 °C
Compensated temperature range	- 10 °C to 50 °C
Safe Overload	1.5 x Capacity
Input Impedance	400 ± 10 Ohms
Output Impedance	350 ± 3 Ohms
Insulation Resistant	> 2,000 Meg - Ohms
Recommended Excitation	10 V DC/AC
Maximum Excitation	15 V DC/AC
Cable Length	6 m
Environmental Protection	IP 68

### Cable Color Code

Red	+ Excitation
Black	- Excitation
Green	+ Signal
White	- Signal